

SECOND FLOOR

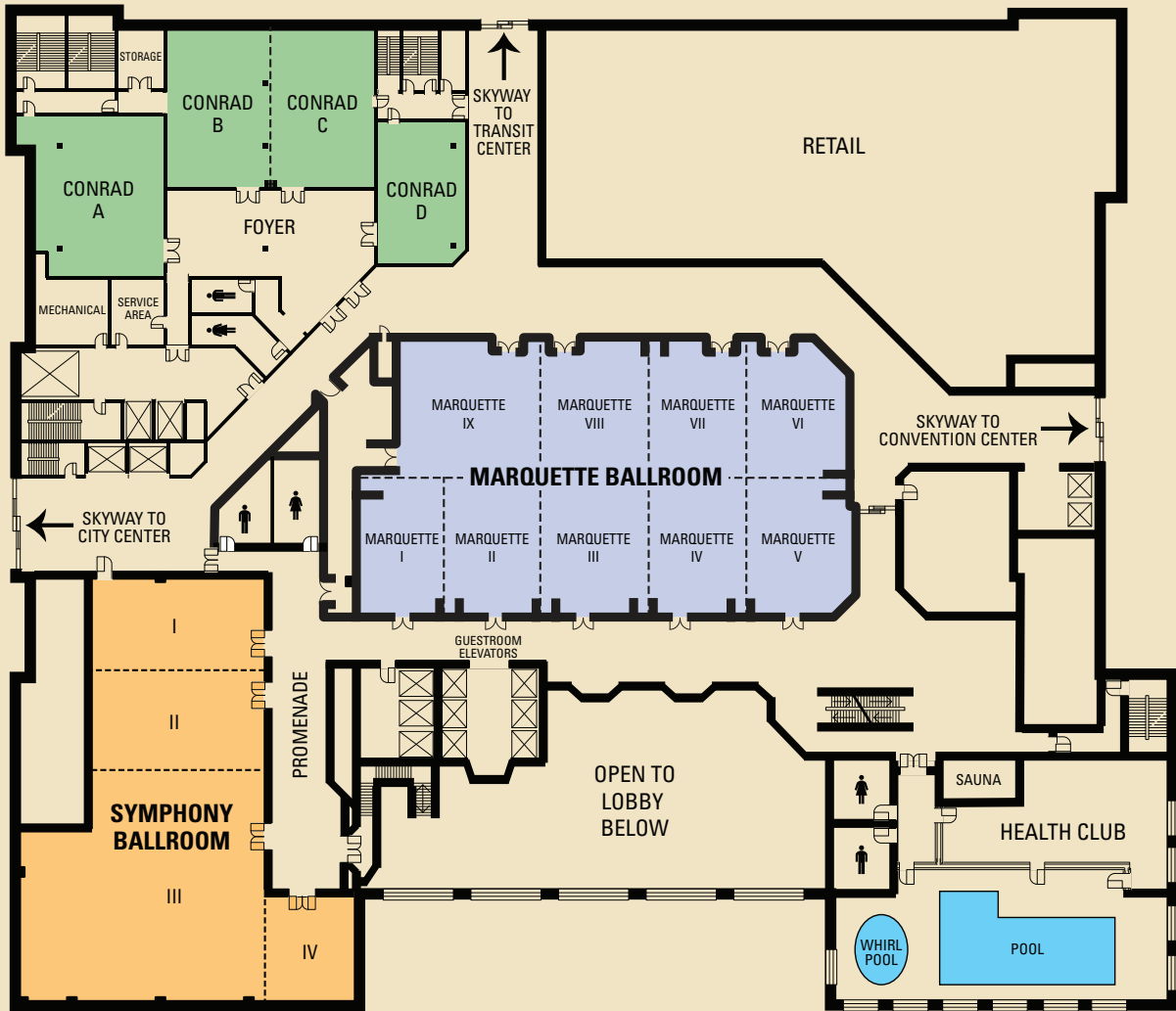

SECOND FLOOR

| | Dimensions | Sq. Footage | Height | Theater | Classroom | Banquet | Reception | Conference | Hollow Sq. | U-Shape |
|--------------------|------------|-------------|--------|---------|-----------|---------|-----------|------------|------------|---------|
| MARQUETTE BALLROOM | 138' x 78' | 10,033 | 11' | 1,050 | 550 | 720 | 1,125 | 54 | 76 | 65 |
| MARQUETTE I | 24' x 39' | 935 | 11' | 100 | 48 | 70 | 110 | 28 | 36 | 30 |
| MARQUETTE II | 27' x 39' | 1,039 | 11' | 110 | 60 | 80 | 120 | 28 | 36 | 30 |
| MARQUETTE III | 30' x 39' | 1,172 | 11' | 125 | 68 | 80 | 130 | 28 | 36 | 30 |
| MARQUETTE IV | 27' x 39' | 1,049 | 11' | 110 | 60 | 80 | 120 | 28 | 36 | 30 |
| MARQUETTE V | 31' x 39' | 1,148 | 11' | 125 | 68 | 80 | 130 | 28 | 36 | 30 |
| MARQUETTE VI | 29' x 39' | 1,026 | 11' | 110 | 60 | 70 | 120 | 28 | 36 | 30 |
| MARQUETTE VII | 27' x 39' | 1,011 | 11' | 110 | 60 | 70 | 120 | 28 | 36 | 30 |
| MARQUETTE VIII | 30' x 39' | 1,123 | 11' | 125 | 68 | 80 | 130 | 28 | 36 | 30 |
| MARQUETTE IX | 40' x 39' | 1,530 | 11' | 155 | 72 | 100 | 165 | 28 | 45 | 36 |
| PRE-FUNCTION | | 1,100 | | | | | | | | |
| SYMPHONY BALLROOM | 95' x 104' | 7,399 | 10'6" | 615 | 245 | 500 | 750 | — | — | — |
| SYMPHONY I | 49' x 32' | 1,543 | 10'6" | 140 | 75 | 110 | 160 | 33 | 48 | 40 |
| SYMPHONY II | 49' x 29' | 1,413 | 10'6" | 115 | 48 | 80 | 150 | 33 | 42 | 37 |
| SYMPHONY III | 71' x 59' | 3,749 | 10'6" | 390 | 162 | 260 | 425 | 48 | 60 | 52 |
| SYMPHONY IV | 25' x 28' | 694 | 10'6" | 60 | 38 | 60 | 80 | 20 | 25 | 22 |
| SYMPHONY PROMENADE | | 1,750 | 10'6" | | | | | | | |
| CONRAD A | 33' x 48' | 1,584 | 10'4" | 150 | 75 | 140 | 200 | 33 | 48 | 40 |
| CONRAD B | 28' x 48' | 1,344 | 10'4" | 130 | 68 | 100 | 150 | 28 | 36 | 30 |
| CONRAD C | 25' x 48' | 1,200 | 10'4" | 115 | 62 | 80 | 130 | 28 | 36 | 30 |
| CONRAD B & C | 53' x 48' | 2,544 | 10'4" | 245 | 130 | 180 | 280 | 54 | 58 | 52 |
| CONRAD D | 32' x 36' | 1,152 | 10'4" | 110 | 58 | 80 | 100 | 28 | 36 | 30 |
| CONRAD FOYER | | 1,512 | 10'4" | — | — | — | 180 | — | — | — |

THIRD FLOOR



THIRD FLOOR

| | Dimensions | Sq. Footage | Height | Theater | Classroom | Banquet | Reception | Conference | Hollow Sq. | U-Shape | |
|--------------------------------|-------------|-------------|--------|--------------------------------|-----------|---------|-----------|------------|------------|---------|--|
| MINNEAPOLIS BALLROOM | 118' x 210' | 24,780 | 20' | 2,576 | 1,440 | 1,950 | 2,850 | — | — | — | |
| MINNEAPOLIS BALLROOM A | 71' x 39' | 2,769 | 20' | 290 | 162 | 200 | 320 | 54 | 76 | 65 | |
| MINNEAPOLIS BALLROOM B | 71' x 39' | 2,769 | 20' | 300 | 162 | 200 | 320 | 54 | 76 | 65 | |
| MINNEAPOLIS BALLROOM C | 71' x 39' | 2,769 | 20' | 290 | 162 | 200 | 320 | 54 | 76 | 65 | |
| MINNEAPOLIS BALLROOM A + B + C | 118' x 71' | 8,378 | 20' | 930 | 496 | 660 | 960 | 162 | 228 | 195 | |
| MINNEAPOLIS BALLROOM D | 118' x 71' | 8,378 | 20' | 1,010 | 524 | 700 | 960 | 162 | 228 | 195 | |
| MINNEAPOLIS BALLROOM E | 68' x 39' | 2,652 | 20' | 270 | 162 | 200 | 305 | 54 | 76 | 65 | |
| MINNEAPOLIS BALLROOM F | 68' x 39' | 2,652 | 20' | 280 | 162 | 200 | 305 | 54 | 76 | 65 | |
| MINNEAPOLIS BALLROOM G | 68' x 39' | 2,652 | 20' | 270 | 162 | 200 | 305 | 54 | 76 | 65 | |
| MINNEAPOLIS BALLROOM E + F + G | 118' x 68' | 8,024 | 20' | 880 | 496 | 660 | 920 | 162 | 228 | 195 | |
| PRE-FUNCTION | | 13,250 | 13' | — | — | — | 1,200 | — | — | — | |
| ROCHESTER | 51' x 35' | 1,785 | 11' | 132 | 64 | 150 | 205 | 35 | 54 | 46 | |
| BOARD ROOM 1 | 26' x 24' | 624 | 10' | 50 | 27 | 50 | 60 | 20 | 25 | 22 | |
| BOARD ROOM 2 | 26' x 26' | 676 | 10' | Permanent Boardroom Set for 10 | | | | | | | |
| BOARD ROOM 3 | 26' x 26' | 676 | 10' | Permanent U-Shape Set for 16 | | | | | | | |
| DIRECTORS ROW 1 | 26' x 26' | 676 | 10' | 50 | 27 | 50 | 60 | 20 | 25 | 22 | |
| DIRECTORS ROW 2 | 26' x 24' | 624 | 10' | 50 | 27 | 50 | 60 | 20 | 25 | 22 | |
| DIRECTORS ROW 3 | 26' x 24' | 624 | 10' | 50 | 27 | 50 | 60 | 20 | 25 | 22 | |
| DIRECTORS ROW 4 | 26' x 24' | 624 | 10' | 50 | 27 | 50 | 60 | 20 | 25 | 22 | |
| RED WING ROOM | 40' x 26' | 1,040 | 10' | 75 | 42 | 80 | 100 | 28 | 36 | 30 | |
| DULUTH | 65' x 33' | 2,145 | 12' | 150 | 96 | 170 | 250 | 52 | 64 | 58 | |